

plexi led

universal, two-sided emergency lighting fitting

Materials:

- steel sheet base painted silver or white, plexi glass

Mounting:

- dry-wall ceiling

Specification:

- 230V 50Hz power supply
- Charge time - 24 hours
- Electric power network and battery charge LED indicator
- High-temperature nickel-cadmium batteries
- LED 96 cd diodes or fluorescent lamp 8W
- Insulation class I
- Protection level IP20
- Ambient temperature: 0°C to +40°C
- Electronic protection against complete battery discharge
- Emergency operation time 3 hours
- Recognition distance 30 m
- Connecting clips 3 x 2,5 mm²
- Compatibility with standard specifications EN 60598, EN 1838
- Optional PT or RS



STANDARD

Configuration of fitting

type	time [h]	work		option	
PL	3	SE	SA	PT	RS

AUTOTEST

Configuration of fitting

type	time [h]	autotest	work		power [W]
PL	3	AT	SE	SA	8

FOR CENTRAL BAT.

Configuration of fitting

type	central bat.
PL	CB

NETWORK

Configuration of fitting

type	network
PL	S

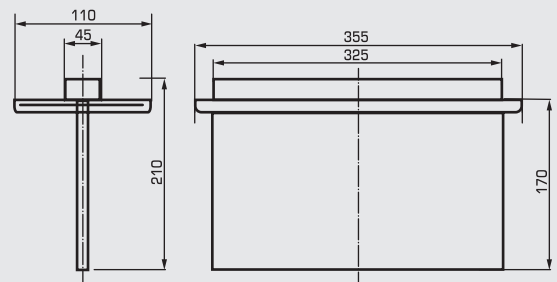

Legend:

- | | |
|------------------------------|------------------------------|
| SE - non-maintained | AT - autotest |
| SA - maintained | S - network |
| PT - manual test button | CB - for central battery evg |
| RS - rubic monitoring system | PL - plexi led fitting |

